

**ESKY**

WWW.ESKY-SZ.COM

主旋翼直径:	595mm
尾旋翼直径:	125mm
熄火降落副齿:	60T
机身长:	520mm
全配重量:	350g
发动机型号:	370 8T/9T
主旋翼传动齿:	140T
尾旋翼传动齿:	12T
电池:	11.1V 1000mAh 锂聚合物电池包
发射机:	6CH CCPM
接收机:	6CH
陀螺仪:	压电式 ESKY 自制
伺服器:	重量 8g, 出力 1.3kg/CM, 速度 0.12s/60
电机:	20A
主旋翼齿轮传动比:	1:17.5/1:15.56
尾旋翼齿轮传动比:	1:3.5/1:3.11

# HONEY BEE KING

## 直升机说明

### EK1H-E008

增强370电机，采用棒式碳刷，电机使用寿命是普通370电机的几十倍。完美的后盖设计可大电流工作。使这款电机的动力增强以至于与无刷电机媲美。

倾斜盘+剪型臂+贝尔控制+希拉控制，四项控制设计是完美的结合让您感受到电动直升机也能有如此准确的飞行控制。

CCPM的结构设计，使三个8g的小伺服器完全有足够的扭力承受疯狂3D飞行。

轻巧的电池架和滑撬的设计使这部机有足够的动力来做疯狂飞行。

Super 370 motor which adopts virgulate brush motor makes its singtime much longer than the normal one. This motor can supply large current with the perfect design, which strengthen its motivity and can compare favourably with the brushless motor. The excellent combination of CCPM control system, forficiform arm machine, Hilar and Bell system give you a precise flight control in this helicopter.

The design of CCPM control system combines the torque of three servo(8g), which provide you a amazing 3D performance with enough torque.

With the portable design of battery holder and skid, this product has as enough motivity to provide the dramatic actions.

main blade diameter:	595mm
tail blade diameter:	125mm
auto-cut side-gear:	60T
length:	520mm
light Weight:	350g
motor type:	370 8T/9T
main rotor drive gear:	140T
tail rotor drive gear:	12T
battery:	11.1V 1000mAh Li-polymer
transmitter:	6CH CCPM
receiver:	6CH
gyro:	Piezo Gyro/Head lock Gyro
servo:	8g 1.3kg/CM 0.12s/60
SD:	20A
main rotor gear drive rate:	1:17.5/1:15.56
tail rotor gear drive rate:	1:3.5/1:3.11

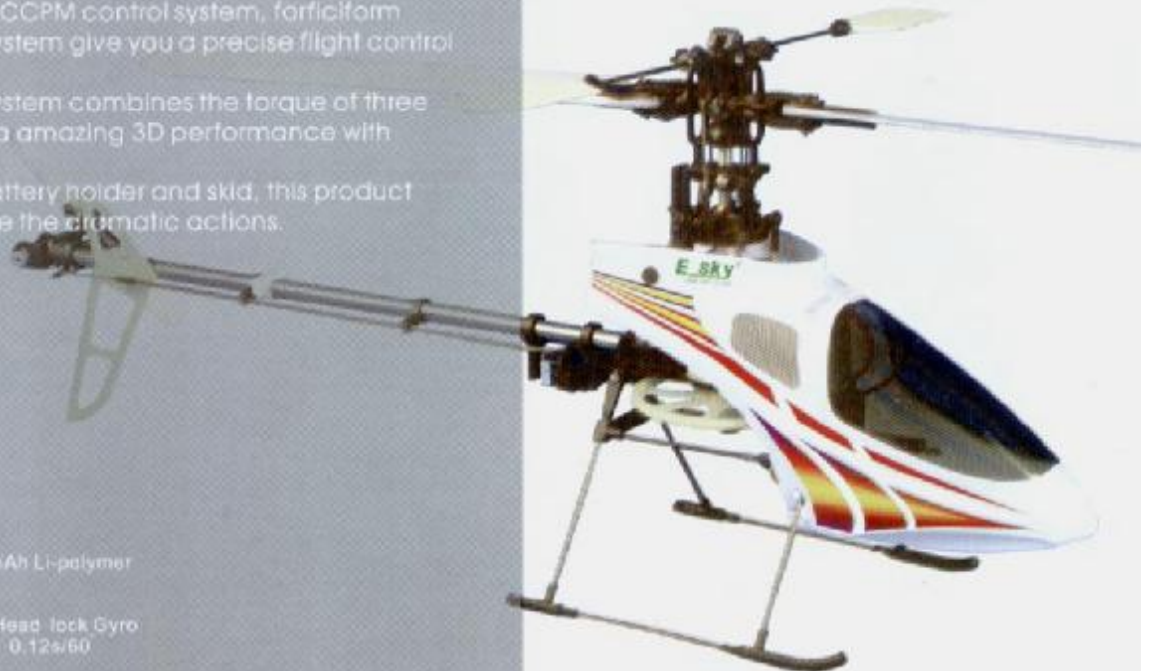

## 前言

感谢您选择易思凯产品，为了您更加了解使用这款直升机，请您详细的阅读本品所配备的说明书后再进行组装以及操作这台直升机，并请妥善的保存好说明书，以便以后对直升机的调整或是维修的参考。这款直升机是由易思凯自行研发的新产品，不论您是需求飞行稳定性的初学者还是追求性能的飞行爱好者都将是您的最佳选择。

## 重要声明

易思凯公司所生产的遥控模型并非玩具，它是结合了多种高科技技术设计出来的休闲产品，在操作过程中具有一定的危险性，所以使用之前应谨慎，以保自身安全。模型产品属于操作技术性和消耗性的商品，如经拆装使用而造成不同程度的零件磨损，在任何使用情况下所造成商品的不良反应将无法确保更换新产品或退货。如果您在使用过程中有任何操作中疑问或维修问题，本公司将愿意为您提供免费的技术指导，和零件特惠服务。

注意：遥控模型飞机，直升机属高危险性商品，飞行时务必远离人群，人为组装不当或机件，电子控制设备损坏，以及操控上的不熟练，都有可能造成飞行失控等意外，请飞行者务必注意飞行安全，并需了解承担发生任何意外的责任。

## 安全注意事项

### 远离障碍物

直升机飞行时具有一定的速度，相对的潜在一定的危险性，所以场地的选择也十分重要。要注意必须选择在四周没有人，建筑物，高层建筑，高压电线，树木等的环境，避免操控的不当造成自己与他人的安全及财产损失的问题。请勿在下雨，打雷等恶劣的气候下操作，以确自身及机体的安全。初学者建议在空旷场地飞行，并可适当搭配练习架练习飞行，这样能够很大程度的保护飞机，降低飞行时失误所造成的损坏。

### 避免独自操控

在飞机场或其附近飞行之前，需确认是否有相同频率的飞行器正进行飞行，否则将导致干扰等危险造成严重后果。遥控飞机操控技巧在学习初期有着一定的难度，要尽量避免独自操控飞行，最好请有经验的人士在旁指导。

### 远离运转中零件

当直升机主旋翼与尾旋翼运转时，切勿触摸并且使直升机远离其他物件，以避免造成危险和损害。

### 远离潮湿环境

由于直升机内部是由许多精密的电子零件组成，所以必须绝对的防止潮湿和水气，避免在浴室或是下雨天使用，以防止水气进入机身内部而导致故障或引发意外。

### 远离热源

一般，由于遥控飞机是以PVC或聚乙烯为主要材料，所以尽量远离热源，避免因高温而变形甚至发生熔毁的可能。

Thank you for purchasing ESKY products. For you take easy to use full featured ESKY Helicopter R/C model capable of all forms of rotary flight, please read the manual carefully before assembling the model, and the following all precautions and recommendations located within the manual. Be sure to retain the manual for future reference, routine maintenance, and the tuning. The Honey bee Cool, Honey bee king and Lama are new products developed by ESKY. They features the best design available on the micro-helicopter market to date, providing flying stability for beginner, full aerobatic capability for advanced pilot, and unsurpassed reliability for customer support.

### Important notes

R/C helicopters, including the Honey bee series are not toys. R/C helicopters utilize various high-tech products and technologies to provide superior performance. The rotating blades on the model spin at high speed and can cause potential risk or injury if use improperly. It is mandatory that you observe all R/C safety rules and adhere to local laws as applicable. We recommend that you contact your local hobby store and inquiry about safety, rules, regulations, and local laws and statutes regarding R/C model operation in your area. Please make sure to be conscious of your own personal safety and the safety of others and your environment when operating all ESKY products. When use properly, ESKY products will provide years of R/C entertainment.

We recommend that you obtain the assistance of an experienced pilot before attempting to fly our products for the first time. A local expert is the best way to properly assemble, set up, and fly your model for the first time.

The ESKY helicopter requires a certain degree of skill to operate, and it a consumer items, any damage or unsatisfaction as a result of accidents or modification are not covered by any warrantee and can not be returned for repair or replacement. Please contact our distributors for free technical consultation and parts at discounted rates when you experience problems during operation or maintenance.

Note: please fly only in safe areas, away from other people. Do not operate R/C aircraft within the vicinity of homes or crowdsof people. R/C aircraft are prone to accidents, failures, and crashes due to a variety of reasons including, lack of maintenance, pilot error, and radio interference. Pilots are responsible for their actions and damage or injury occurring during operation or as of result of R/C aircraft models.

### Warning

#### Locate an appropriate location

R/C helicopter fly at high speed, thus posing a certain degree of potential danger. Choose an appropriate flying site consisting of flat, smooth ground, a clear open field, or a large open room. Do not fly near buildings, high voltage cables, or trees to ensure that safety of yourself, others, and your model. Do not fly your model in

#### Obtain the assistance of an experienced pilot

Before turning on your model and transmitter, check to make sure no one else is operating on the same frequency. Frequency interference can cause your model, or other model to crash. The guidance provided by an experienced pilot will be invaluable for the assembly, tuning, trimming, and actual first flight.

#### Always be aware of the rotating blade

During the operation of the helicopter, the main rotor and tail rotor will be spinning at a high rate of speed. The blades are capable of inflicting serious bodily injury and damage to the environment. Be conscious of your actions, and careful to keep your face, eyes, hands, and loose clothing away from the blades. Always fly the model a safe distance from yourself and others, as well as surrounding objects. Never take your eyes off the model or leave it unattended while it is turned on. Immediately turn off the model and transmitter when you have landed the model.

#### Prevent moisture

R/C model are composed of many precision electronic components. It is critical to keep the model and associated equipment away from moisture and other contaminants. The introduction or exposure to water or moisture in any form can cause the model to malfunction resulting in loss of use, or crash. Do not operate or expose to rain or moisture.

#### Keep away from heat

R/C model are made up various forms of plastic. Plastic is very susceptible to damage or deformation due to heat. Make sure not to store the model near any source of heat such as oven, or heater. It is best to store the model indoors, in a climate-controlled, room temperature environment.

# HONEY BEE KING

# EK1H-E008A

## ORDER NO . ILLUSTRATION



EKI-0006



3\*6\*2.5

EKI-0213



2\*6\*3

EKI-0218

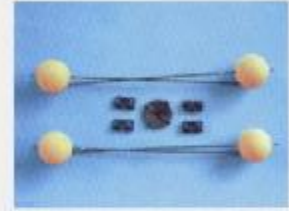

EKI-0221

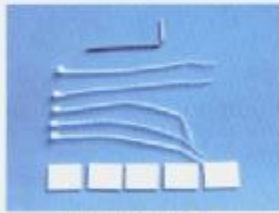

EKI-0222



EKI-0224

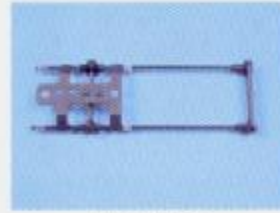

EKI-0237



EKI-0239

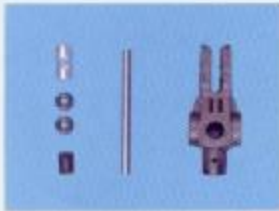

EKI-0280

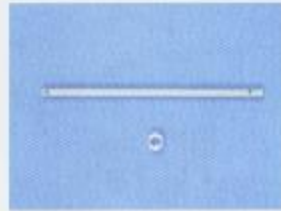

EKI-0281



EKI-0282



EKI-0283

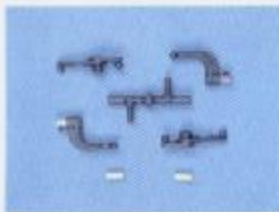

EKI-0284



EKI-0285



EKI-0286



EKI-0287



EKI-0288



EKI-0289

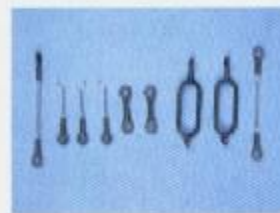

EKI-0290



EKI-0291



EKI-0292



EKI-0293

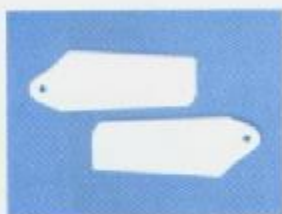

EKI-0294



EKI-0295

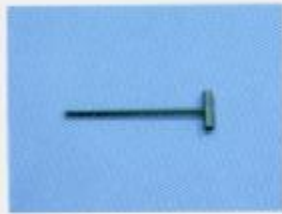

EKI-0296



EKI-0297



EKI-0298



EKI-0301



EKI-0302



EKI-0303



EKI-0304



EKI-0305



EKI-0309A



EKI-0329



EKI-0331



EKI-0336



EKI-0337



EKI-0339



EK2-0401A



EK2-0420



EK2-0500



EK2-0704



EK4-0004

## 组装程序/Assembly procedure

### 各部零件与设备装配图示/Assembly diagram of each spare part and equipment

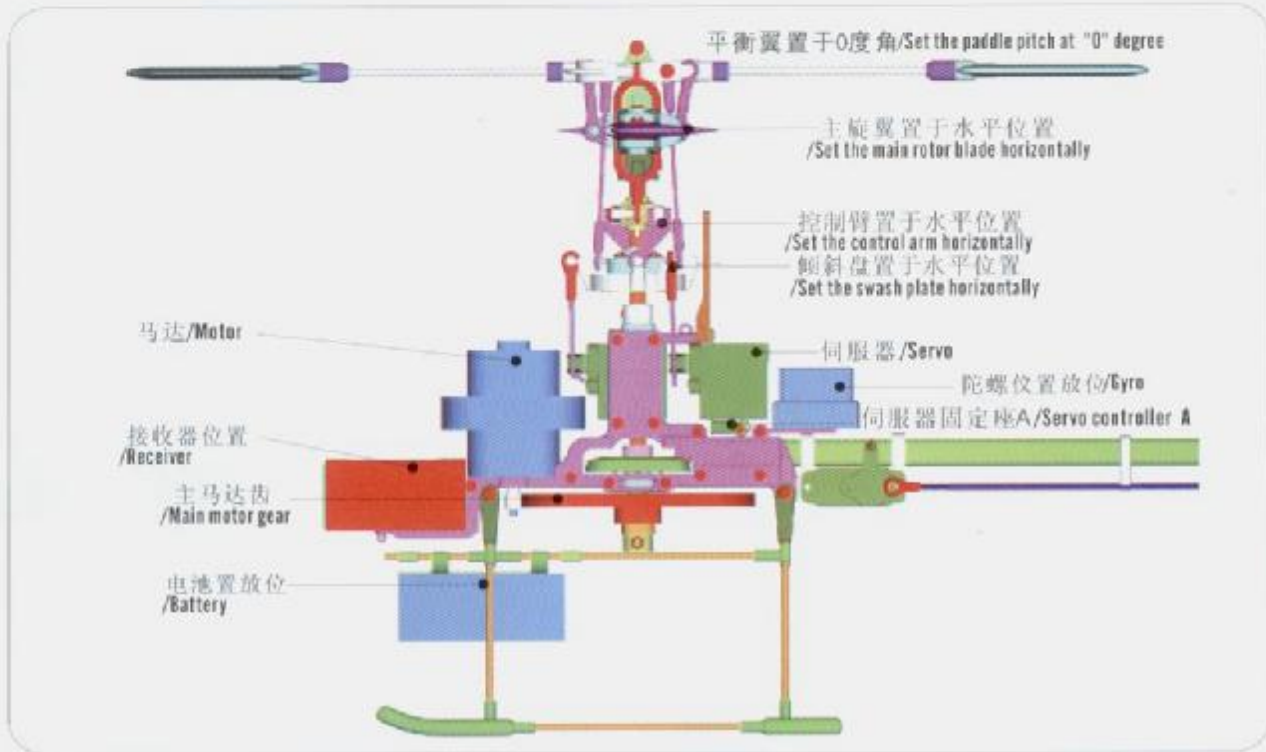

### 接收器、伺服器连接频道说明/connection diagram of receiver and servo

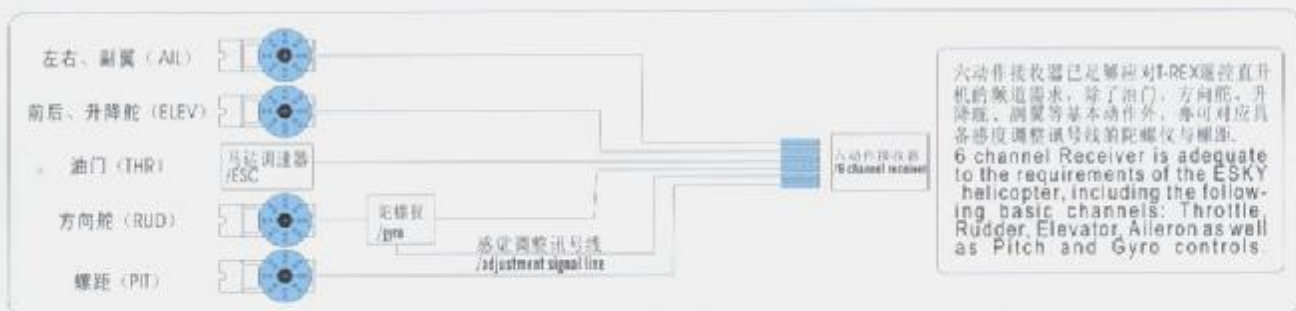

### PITCH设定建议说明 (飞行前主旋翼设定) /Final pre-flight adjustments

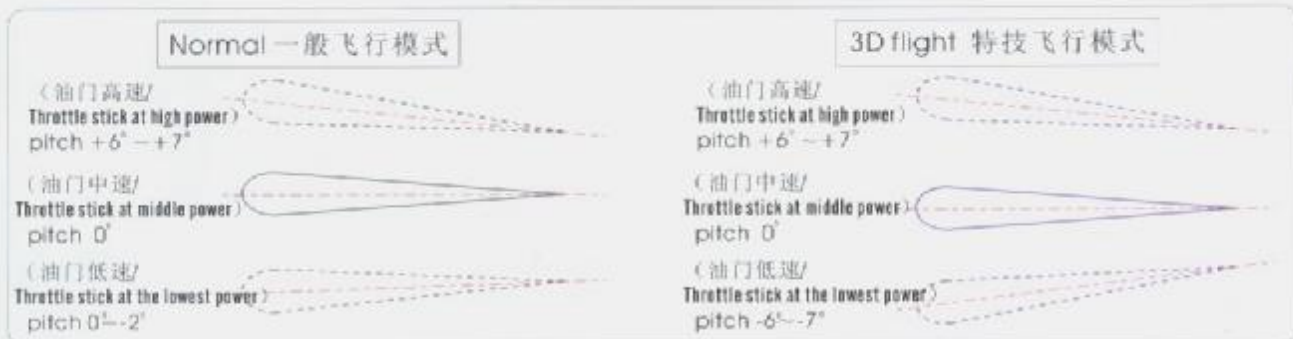

## 稳定翼组装步骤/Assembly process of paddles

### 零件用量表/Dosage form of spare parts

序号NO	包装Packing	品名Name	数量Quantity	序号NO	包装Packing	品名Name	数量Quantity	序号NO	包装Packing	品名Name	数量Quantity
001	I	稳定翼paddle	2	009	H	贝尔控制臂Bell control arm	2	046	H	TPF1.7*3TPF1.7*3 screw	2
002	I	稳定翼固定轴paddle fixed shaft	2	010	H	贝尔黄铜衬Bell arm copper cushion	2	034	H	铜瓦copper cover	2
003	H	M3*3内六角无头螺丝M3 screw	4	011	F	平衡翼杆flybar	1	033	H	主翼夹头main blade clamp	2
004	H	平衡翼固定环paddle collar	2	012	H	平头十字螺丝TPF1.7*4 TPF1.7*4 screw	2	036	H	M2*6内六角螺丝M2*6 screw	2
005	H	平衡翼控制臂paddle arm	2	013	H	轴承03*06*L2.5 bearing 03*06*L2.5	2	037	L	主翼夹片A main blade collet A	2
006	H	平衡杆中心座flybar center holder	1	030	H	主翼固定轴 main blade shaft	1	038	L	副翼夹片B serrolol collet B	2
007	H	平头十字螺丝TPF1.7*4 TPF1.7*4 screw	2	031	H	"O" 圈 "O" ring	2	039	H	TPF2*5.5螺丝TPF2*5.5 screw	2
008	H	垫片A washer A	2	032	H	垫片E washer E	2	040	L	主翼main blade	2

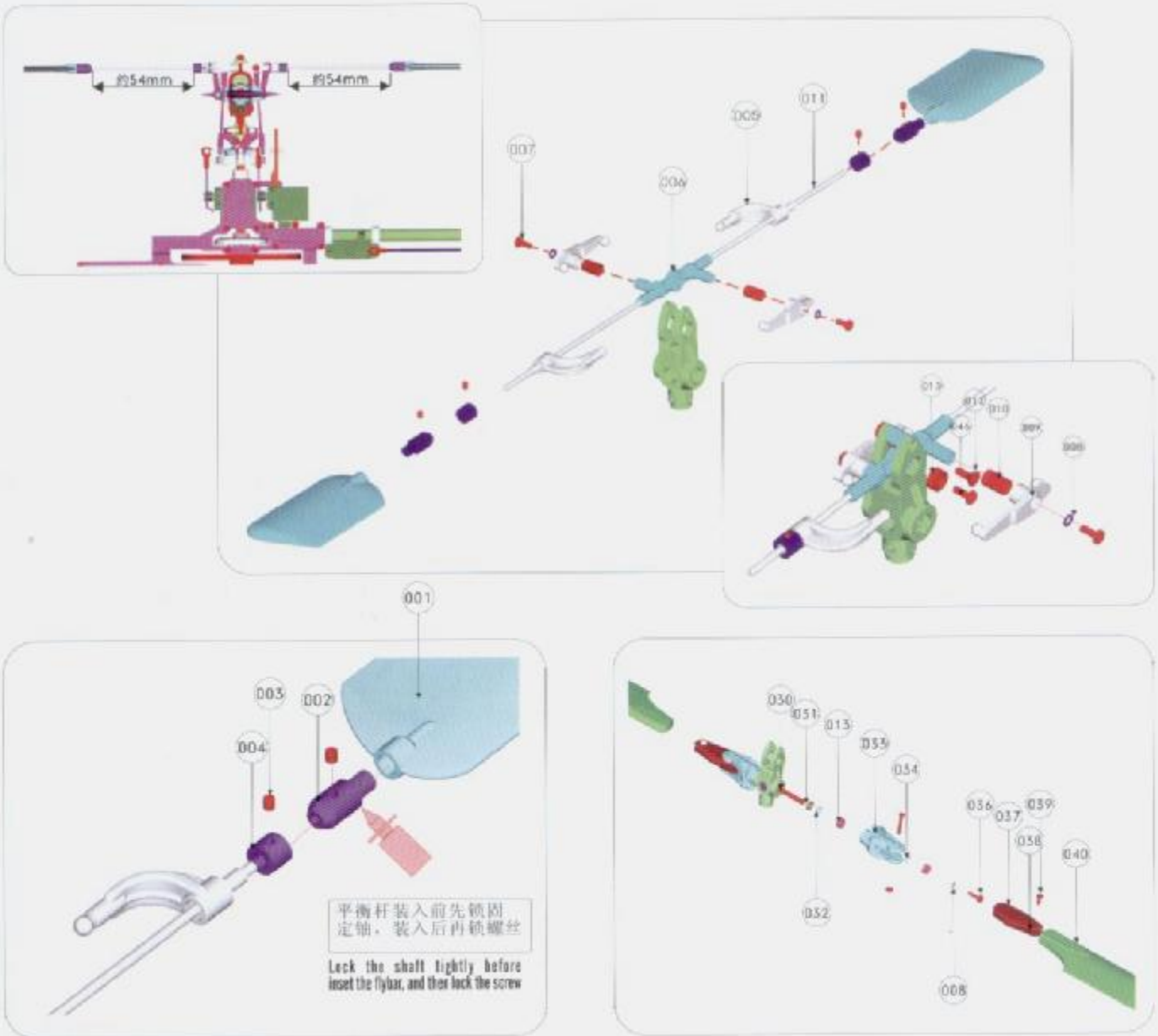

## 主旋翼组组装步骤/Assembly process of main rotor blades

### 零件用量表/Desage form of spare parts

序号NO	包装Packing	品名Name	数量Quantity	序号NO	包装Packing	品名Name	数量Quantity	序号NO	包装Packing	品名Name	数量Quantity
014	H	平衡杆中心座固定件 flybar holder set	1	022	G	希拉控制臂 rotor head control arm	2	041	G	倾斜内盘A swash plate(inner) A	1
015	H	主旋转头center hub set	1	023	G	剪型臂for ticform arm	2	042	G	铜球copper ball	1
016	H	M2*14 沉头螺丝 M2*14 screw	2	024	G	希拉臂衬套B arm bush B	2	043	G	滚动轴承20*27*4 20*27*4 bearing	1
123	H	M2.5 普通螺母 M2.5 nuts	2	025	G	剪型臂衬套for ticform arm bush	2	044	G	倾斜外盘swash plate(outer)	1
018	H	固定塞fixed plug	1	026	G	希拉臂衬套A arm bush A	2	045	G	倾斜内盘B swash plate(inner) B	1
019	H	中心座center holder	1	027	G	剪型臂固定销for ticform arm fixed pin	2	052	B	主轴main shaft	1
020	H	相位差销phasic bolt	2	028	G	伞头M2.0伞头螺丝 M2.0*5	2	112	G	伞头1.7*4 十字螺丝 M1.7*4 screw	4
021	G	中心座滑块center holder block	1	029	G	中心座铜衬center holder bush	1	035	D	M2*12 螺丝 M2*12 screw	1
								017	D	M2 普通螺母 M2 nuts	1

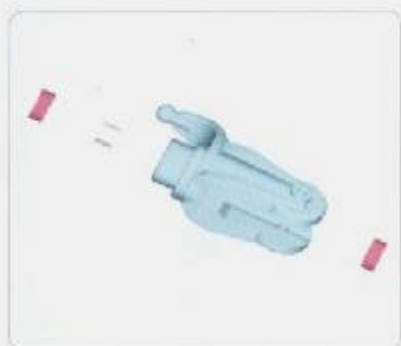
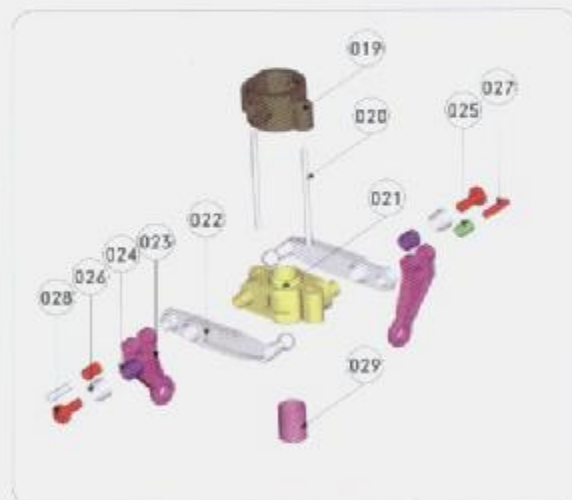
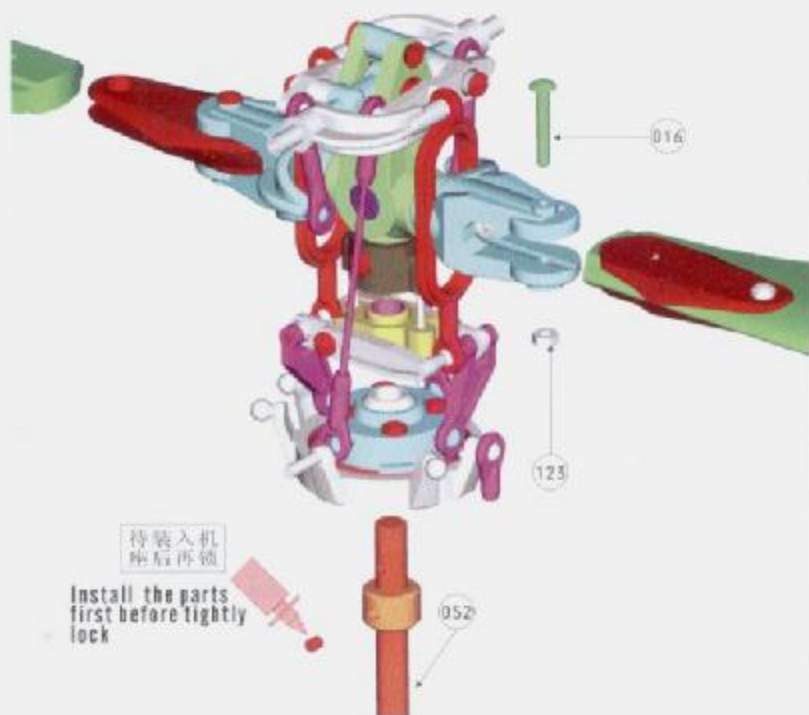

## 动力系统组装步骤/Assembly process of power system

### 零件用量表/Dosage form of spare parts

序号NO	包装Packing	品名Name	数量Quantity	序号NO	包装Packing	品名Name	数量Quantity	序号NO	包装Packing	品名Name	数量Quantity
046	B	TPF 1.7*3TPF1.7*3 screw	3	051	B	单向轴承驱动轴 oneway auto-driven shaft	1	056	J	D单孔拉杆 A single ring push-rod A	7
047	B	辅助齿轮固定盘 auxiliary gear fixed plate	1	053	H	双孔拉杆 ring-like push-rod	2	108	J	拉杆 AM1.4*29 Push-rod AM1.4*29	2
048	B	减速副齿轮 deceleration auxiliary gear	1	054	J	双孔连杆 ring-like linkage	2	003	B	M3*3内六角无头螺栓 M3*3 screw	2
049	B	单向轴承 oneway bearing	1	055	H	连杆 AM1.4*44 linkage AM1.4*44	2	017	B	M2普通螺母 M2 nuts	1
050	B	减速主齿 deceleration main gear	1					035	B	M2*12内六角螺栓 M2*12 screw	1

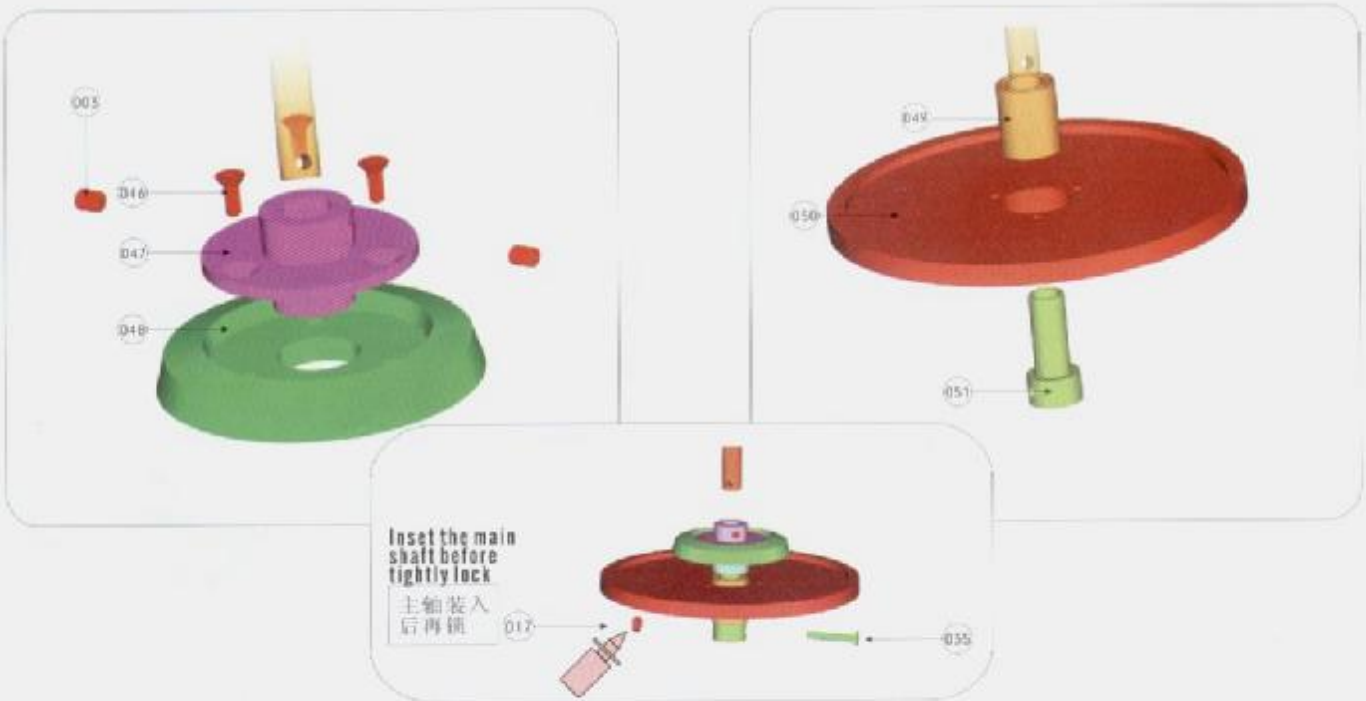

## 机架组组装步骤/Assembly process of main frame set

### 零件用量表/Dosage form of spare parts

序号NO	包装Packing	品名Name	数量Quantity	序号NO	包装Packing	品名Name	数量Quantity	序号NO	包装Packing	品名Name	数量Quantity
057	A	轴承5*10*3 bearing 5*10*3	2	061	M	机壳支杆cabin spacer	1	065	E	滑撬管后套skid tube cap(back)	2
058	A	右侧板right frame	1	062	A	倾斜盘固定板antirotation bracket	1	066	E	滑撬管前套skid tube cap(front)	2
059	M	软胶头soft colloid	2	063	A	左侧板left frame	1	067	E	滑撬支杆skid strut set	4
060	B	定轴环A collar A	1	064	A	TPB1.7*9TPB1.7*9	12	081	E	支架固定后套strut fixed set(back)	1
003	B	M3*3无头内六角螺帽M3 screw	1	028	A	伞头2.0*6umbrella-head screw M2.0*6	2	108	E	透明胶套plastic ring	4
080	E	支架固定前套strut fixed set(front)	1	084	E	电池固定架battery hanger set	1	111	E	电池架支杆battery hanger set	2
109	E	机架支杆main frame strut	4	110	E	滑撬杆skid bar	2	112	E	伞头1.7*4螺帽M1.7*4 screw	4

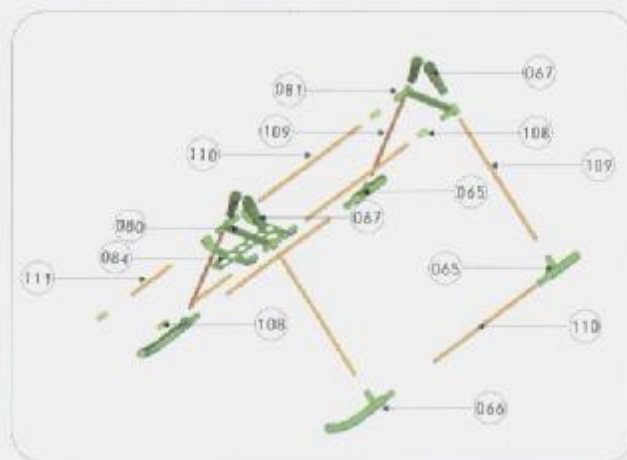
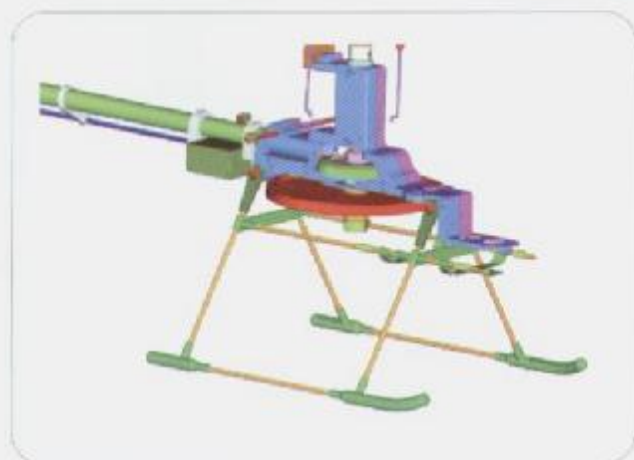
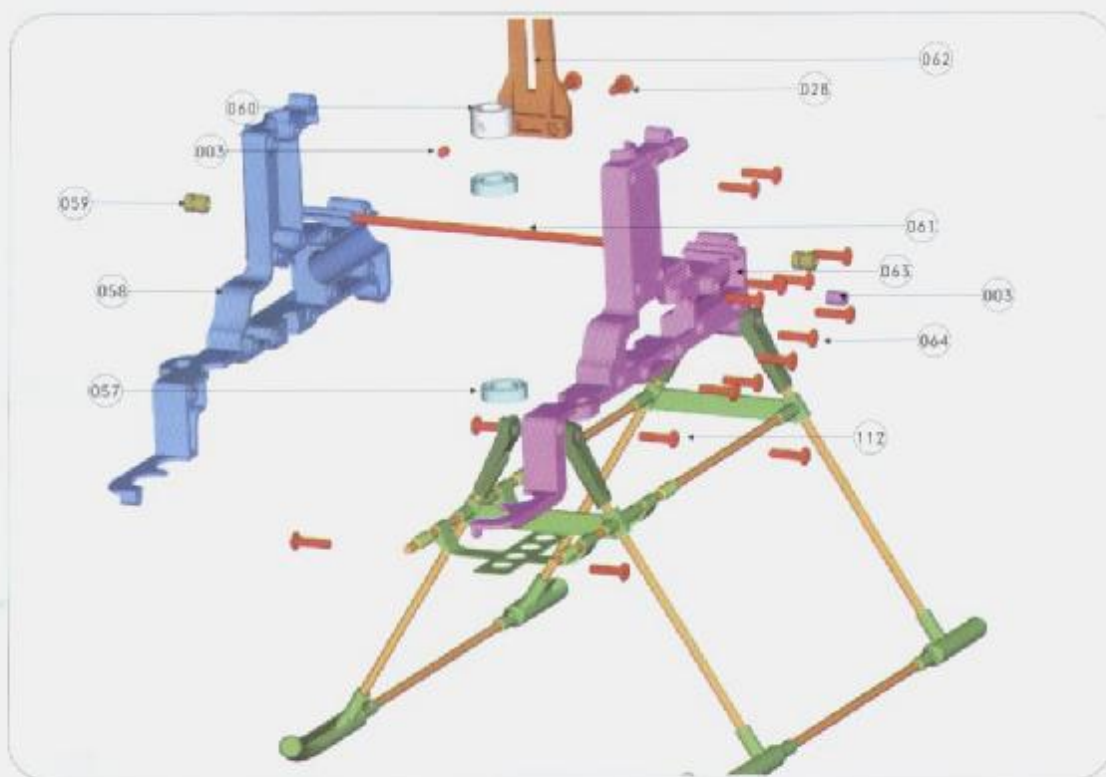

## 尾机翼组组装步骤/Assembly process of tail blade set

### 零件用量表/Dosage form of spare parts

序号NO	包装Packing	品名Name	数量Quantity	序号NO	包装Packing	品名Name	数量Quantity	序号NO	包装Packing	品名Name	数量Quantity
089	K	尾轴tail shaft	1	096	K	尾牙箱右侧板tail gear box(right)	1	103	K	单孔连杆Single ring push-rod B	2
090	K	尾定位环tail shaft collar	1	097	K	尾轴回位衬套tail pitch control set	1	104	K	尾旋翼tail rotor blade	2
091	K	伞头十字螺丝1.2*6 M1.2*6 screw	1	098	K	尾滑座tail rotor holder	1	105	K	内六角螺丝M2*8 M2*8 screw	2
092	K	TP8 1.4*7螺丝TP8 1.4*7 screw	6	099	K	尾摇臂tail rotor control arm	1	106	K	尾翼夹头tail blade clamp	2
093	K	尾牙箱左侧板tail gear box(left)	1	100	K	尾摇臂衬套A tail rotor control arm bush A	1	107	K	尾翼固定轴tail blade fixed shaft	1
094	K	尾伞齿C tail gear C	1	101	K	尾摇臂衬套B tail rotor control arm bush B	1	003	K	M3的六角无头螺丝M3 screw	1
095	K	轴承2*6*3 bearing 2*6*3	3	102	K	尾中心座滑套tail rotor control holder	1	013	K	轴承D3*D6*L2.5 bearing D3*D6*L2.5	3
112	K	伞头1.7*4螺丝M1.7*4 screw	1	008	K	垫片A washer A	3	108	K	胶套plastic ring	1

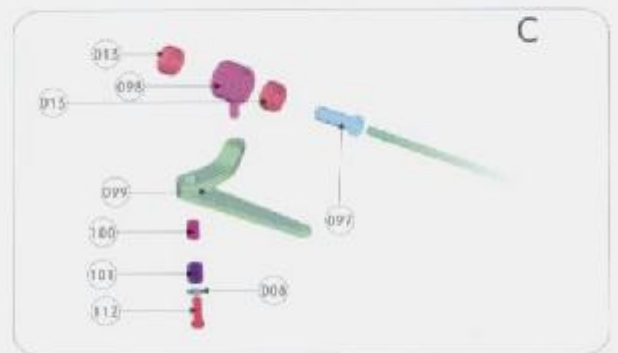
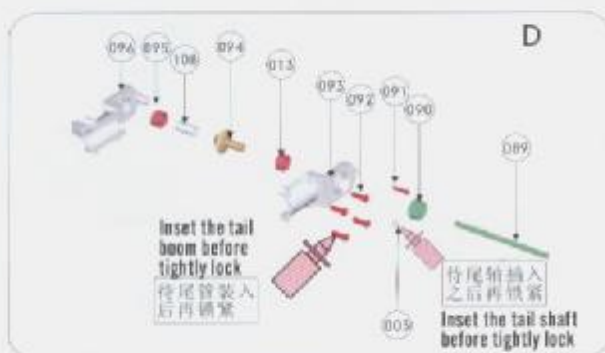
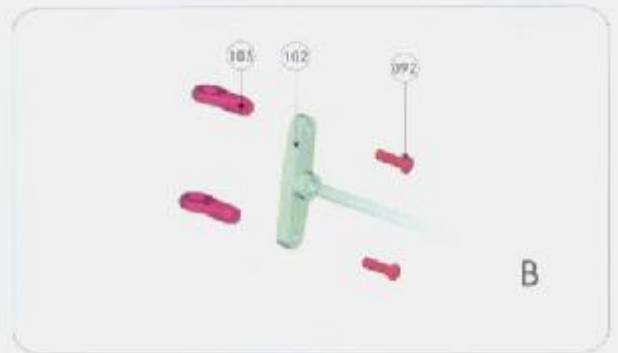
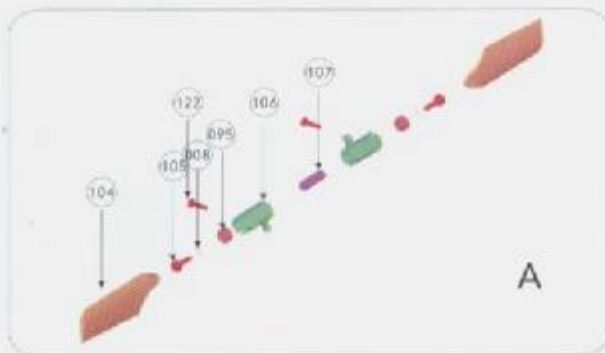
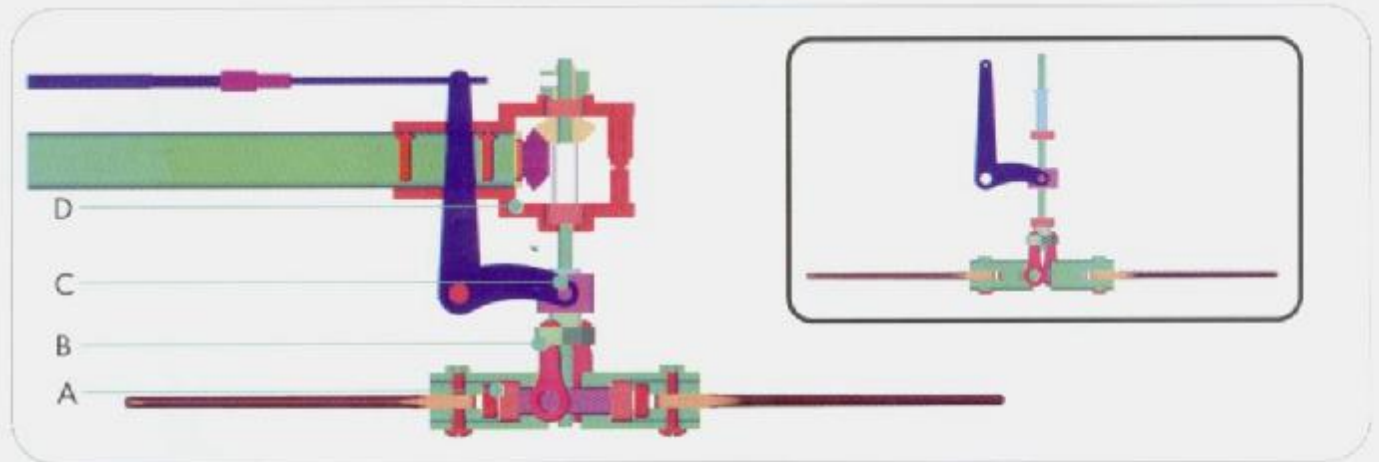

## 尾管组组装步骤/Assembly process of tail boom set

### 零件用量表/Dosage form of spare parts

序号NO	包装Packing	品名Name	数量Quantity	序号NO	包装Packing	品名Name	数量Quantity	序号NO	包装Packing	品名Name	数量Quantity
068	D	尾传动轴tail drive shaft	1	075	D	尾SERVO摆臂tail servo control arm	1	082	D	单孔连杆C single ring push-rod C	1
069	D	尾伞齿A tail drive gear A	1	076	D	尾拉杆连接球tail push-rod connect-ball	1	083	D	尾拉杆B tail push-rod B	1
070	D	轴承座bearing holder	2	077	D	尾拉管固定件tail push-rod control	2	085	I	垂直翼vertical fin set	1
071	D	尾传动轴固定套tail drive shaft collar	2	078	D	垂直翼水平翼固定件horizontal fin control set	2	086	D	尾拉杆连接件tail push-rod linkage	1
072	D	尾管tail boom	1	079	I	水平翼horizontal fin set	1	087	D	尾拉杆A tail push-rod A	1
073	D	尾SERVO固定座tail servo control set	2	039	D	1PF2*5.5螺丝1PF2*5.5 screw	5	088	D	尾伞齿B tail gear B	1
074	N	伺服器servo	4	013	D	轴承D3*D6*L2.5bearing D3*D6*L2.5	2	112	I	伞头1.7*4十字螺丝M1.7*4 screw	4
				122	K	圆头M2*10M2*10 screw	2	028	D	伞头M2*6umbrella-head screw M2.0*6	2

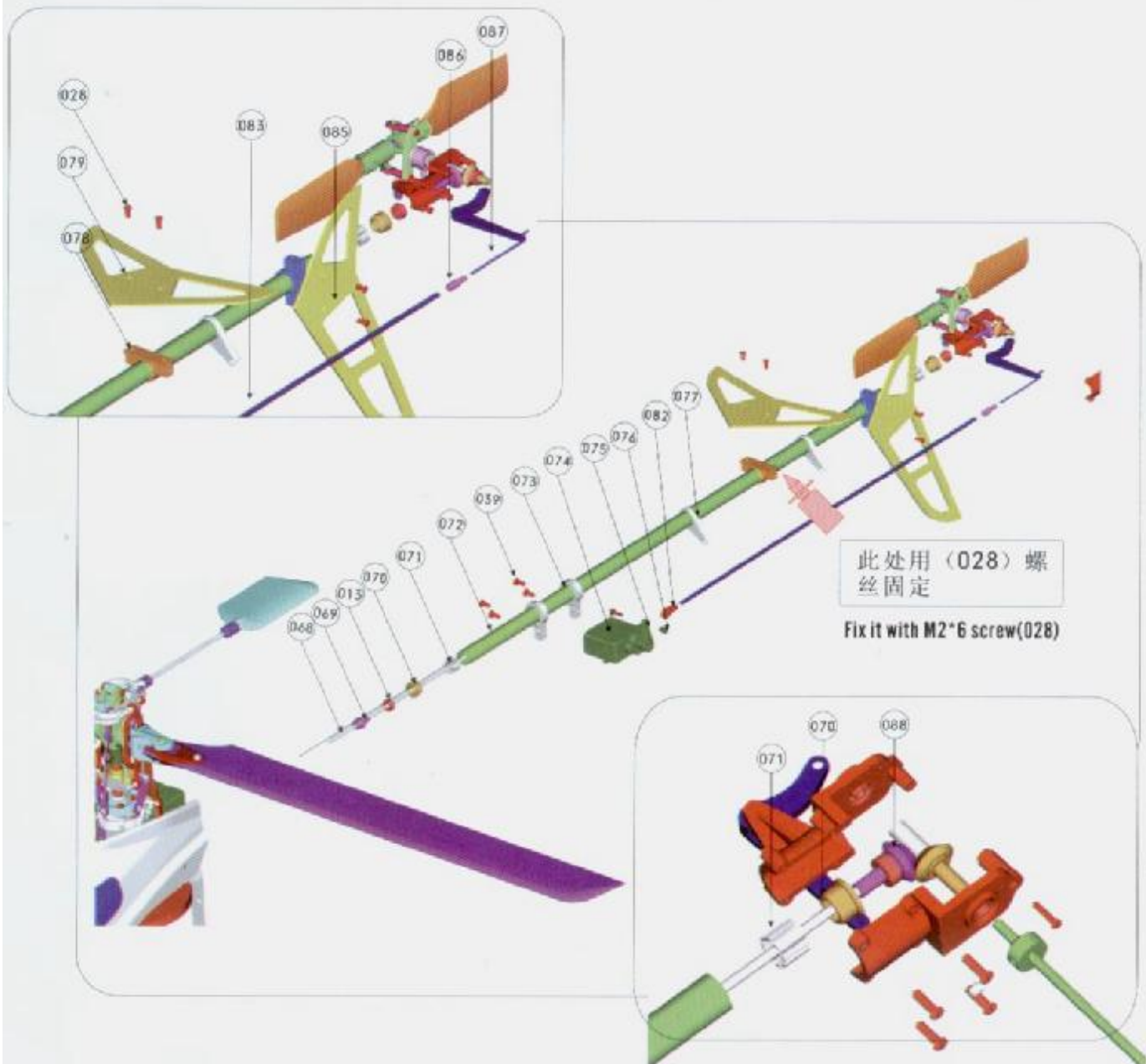

# 散件总览 Expoloded view

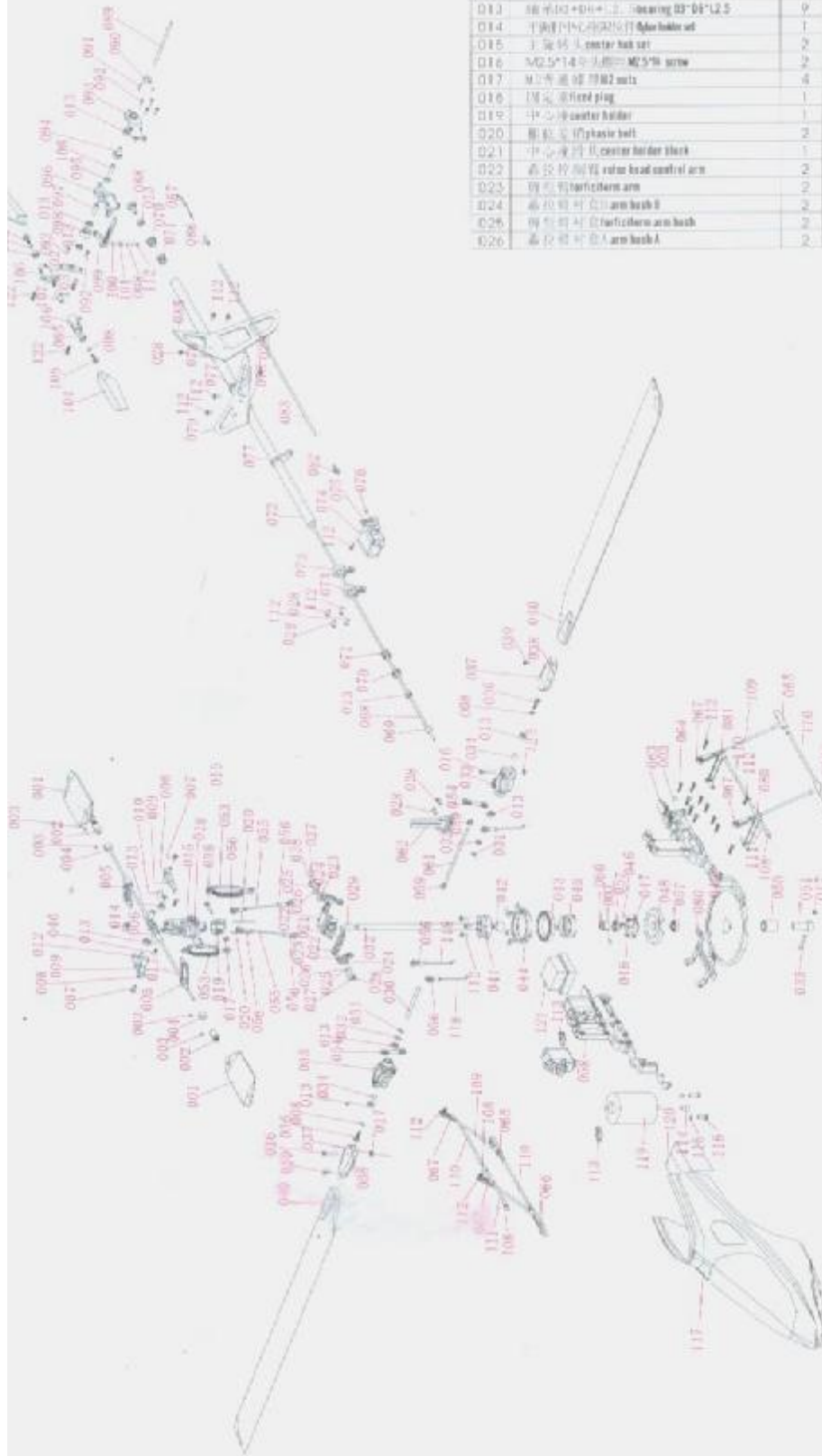

零件号	名称Name	数量Quantity
001	固定轴fixed	2
002	固定轴固定轴固定轴fixed shaft	2
003	固定轴固定轴固定轴固定轴fixed shaft	2
004	平衡翼固定轴固定轴固定轴fixed shaft	2
005	平衡翼控制臂固定轴固定轴fixed arm	2
006	平衡翼中心轴固定轴固定轴fixed center holder	1
007	轴固定轴固定轴固定轴fixed	1
008	轴固定轴固定轴固定轴fixed	5
009	轴固定轴固定轴固定轴fixed control arm	2
010	轴固定轴固定轴固定轴固定轴fixed center holder	2
011	平衡翼控制臂固定轴固定轴fixed	1
012	轴固定轴固定轴固定轴固定轴fixed	6
013	轴固定轴固定轴固定轴固定轴fixed bearing 02-02-12.5	9
014	平衡翼固定轴固定轴固定轴固定轴fixed holder set	1
015	平衡翼固定轴固定轴固定轴固定轴fixed	2
016	M2.5*14轴固定轴固定轴固定轴fixed screw	2
017	M2.5轴固定轴固定轴固定轴固定轴fixed nuts	4
018	固定轴固定轴固定轴固定轴fixed plug	1
019	平衡翼固定轴固定轴固定轴固定轴fixed holder	1
020	平衡翼固定轴固定轴固定轴固定轴fixed belt	2
021	平衡翼固定轴固定轴固定轴固定轴fixed holder block	1
022	平衡翼固定轴固定轴固定轴固定轴fixed control arm	2
023	平衡翼固定轴固定轴固定轴固定轴fixed center holder	2
024	平衡翼固定轴固定轴固定轴固定轴fixed arm bush B	2
025	平衡翼固定轴固定轴固定轴固定轴fixed center holder	2
026	平衡翼固定轴固定轴固定轴固定轴fixed arm bush A	2

零件号	名称Name	数量Quantity
027	平衡翼固定轴固定轴固定轴固定轴fixed center arm fixed pin	2
028	平衡翼固定轴固定轴固定轴固定轴fixed screw M2.0*8	8
029	平衡翼固定轴固定轴固定轴固定轴fixed center holder back	1
030	平衡翼固定轴固定轴固定轴固定轴fixed main blade shaft	1
031	平衡翼固定轴固定轴固定轴固定轴fixed ring	2
032	平衡翼固定轴固定轴固定轴固定轴fixed washer B	2
033	平衡翼固定轴固定轴固定轴固定轴fixed main blade clamp	2
034	平衡翼固定轴固定轴固定轴固定轴fixed escaper cover	2
035	M2*12轴固定轴固定轴固定轴固定轴fixed screw	1
036	M2*12轴固定轴固定轴固定轴固定轴fixed screw	2
037	平衡翼固定轴固定轴固定轴固定轴fixed main blade center A	2
038	平衡翼固定轴固定轴固定轴固定轴fixed center B	2
039	M2*12轴固定轴固定轴固定轴固定轴fixed screw	2
040	平衡翼固定轴固定轴固定轴固定轴fixed main blade	2
041	平衡翼固定轴固定轴固定轴固定轴fixed main blade (inner) B	1
042	平衡翼固定轴固定轴固定轴固定轴fixed escaper ball	1
043	平衡翼固定轴固定轴固定轴固定轴fixed bearing 20*22*428*274 bearing	1
044	平衡翼固定轴固定轴固定轴固定轴fixed main blade (outer) B	1
045	平衡翼固定轴固定轴固定轴固定轴fixed main blade (inner) B	1
046	M2*12轴固定轴固定轴固定轴固定轴fixed screw	6
047	平衡翼固定轴固定轴固定轴固定轴fixed auxiliary gear fixed plate	1
048	平衡翼固定轴固定轴固定轴固定轴fixed auxiliary gear	1
049	平衡翼固定轴固定轴固定轴固定轴fixed main gear bearing	1
050	平衡翼固定轴固定轴固定轴固定轴fixed main gear	1
051	平衡翼固定轴固定轴固定轴固定轴fixed main gear shaft	1
052	平衡翼固定轴固定轴固定轴固定轴fixed main shaft	1
053	平衡翼固定轴固定轴固定轴固定轴fixed ring-like push-rod	2
054	平衡翼固定轴固定轴固定轴固定轴fixed ring-like linkage	2
055	平衡翼固定轴固定轴固定轴固定轴fixed linkage M1.4*44	2
056	平衡翼固定轴固定轴固定轴固定轴fixed single ring push-rod A	7
057	平衡翼固定轴固定轴固定轴固定轴fixed bearing 8*10*3	2
058	平衡翼固定轴固定轴固定轴固定轴fixed right frame	1
059	平衡翼固定轴固定轴固定轴固定轴fixed salt rollers	2
060	平衡翼固定轴固定轴固定轴固定轴fixed collar A	1
061	平衡翼固定轴固定轴固定轴固定轴fixed cabin spacer	1
062	平衡翼固定轴固定轴固定轴固定轴fixed excitation bracket	1
063	平衡翼固定轴固定轴固定轴固定轴fixed left frame	1
064	平衡翼固定轴固定轴固定轴固定轴fixed TPB1, 2*TPB1.2*8	16
065	平衡翼固定轴固定轴固定轴固定轴fixed shield tube cap(back)	2
066	平衡翼固定轴固定轴固定轴固定轴fixed shield tube cap(front)	2
067	平衡翼固定轴固定轴固定轴固定轴fixed shield strut set	4
068	平衡翼固定轴固定轴固定轴固定轴fixed tail drive shaft	1
069	平衡翼固定轴固定轴固定轴固定轴fixed tail drive gear A	1
070	平衡翼固定轴固定轴固定轴固定轴fixed bearing holder	2
071	平衡翼固定轴固定轴固定轴固定轴fixed tail drive shaft collar	2
072	平衡翼固定轴固定轴固定轴固定轴fixed tail boom	1
073	平衡翼固定轴固定轴固定轴固定轴fixed tail servo control set	2
074	平衡翼固定轴固定轴固定轴固定轴fixed servo	4
075	平衡翼固定轴固定轴固定轴固定轴fixed tail servo control arm	1
076	平衡翼固定轴固定轴固定轴固定轴fixed tail push-rod control set	1
077	平衡翼固定轴固定轴固定轴固定轴fixed tail push-rod control	2
078	平衡翼固定轴固定轴固定轴固定轴fixed horizontal bar control set	2
079	平衡翼固定轴固定轴固定轴固定轴fixed horizontal bar set	1
080	平衡翼固定轴固定轴固定轴固定轴fixed strut fixed set(front)	1
081	平衡翼固定轴固定轴固定轴固定轴fixed strut fixed set(back)	1
082	平衡翼固定轴固定轴固定轴固定轴fixed single ring push-rod C	1
083	平衡翼固定轴固定轴固定轴固定轴fixed tail push-rod B	1
084	平衡翼固定轴固定轴固定轴固定轴fixed battery hanger set	1
085	平衡翼固定轴固定轴固定轴固定轴fixed vertical fin set	1
086	平衡翼固定轴固定轴固定轴固定轴fixed tail push-rod linkage	1
087	平衡翼固定轴固定轴固定轴固定轴fixed tail push-rod A	1
088	平衡翼固定轴固定轴固定轴固定轴fixed tail gear B	1
089	平衡翼固定轴固定轴固定轴固定轴fixed tail shaft	1
090	平衡翼固定轴固定轴固定轴固定轴fixed tail shaft collar	1
091	平衡翼固定轴固定轴固定轴固定轴fixed M2*12 screw	1
092	平衡翼固定轴固定轴固定轴固定轴fixed TPB1, 2*TPB1, 4*TPB1, 4*TPB1, 4*TPB1	6
093	平衡翼固定轴固定轴固定轴固定轴fixed gear set(left)	1
094	平衡翼固定轴固定轴固定轴固定轴fixed tail gear C	1
095	平衡翼固定轴固定轴固定轴固定轴fixed bearing 2*8*3	3
096	平衡翼固定轴固定轴固定轴固定轴fixed gear head(right)	1
097	平衡翼固定轴固定轴固定轴固定轴fixed tail push control set	1
098	平衡翼固定轴固定轴固定轴固定轴fixed tail water holder	1
099	平衡翼固定轴固定轴固定轴固定轴fixed tail water control arm	1
100	平衡翼固定轴固定轴固定轴固定轴fixed tail water control arm bush A	1
101	平衡翼固定轴固定轴固定轴固定轴fixed tail water control arm bush B	1
102	平衡翼固定轴固定轴固定轴固定轴fixed tail water control holder	1
103	平衡翼固定轴固定轴固定轴固定轴fixed single ring push-rod B	2
104	平衡翼固定轴固定轴固定轴固定轴fixed water blade	2
105	平衡翼固定轴固定轴固定轴固定轴fixed M2*12 screw	2
106	平衡翼固定轴固定轴固定轴固定轴fixed tail blade clamp	2
107	平衡翼固定轴固定轴固定轴固定轴fixed tail blade fixed shaft	1
108	平衡翼固定轴固定轴固定轴固定轴fixed plastic ring	5
109	平衡翼固定轴固定轴固定轴固定轴fixed main frame steel	4
110	平衡翼固定轴固定轴固定轴固定轴fixed shield bar	2
111	平衡翼固定轴固定轴固定轴固定轴fixed battery hanger set	2
112	平衡翼固定轴固定轴固定轴固定轴fixed M1.4*12 screw	9
113	平衡翼固定轴固定轴固定轴固定轴fixed servo control A	4
114	平衡翼固定轴固定轴固定轴固定轴fixed main motor gear	1
115	平衡翼固定轴固定轴固定轴固定轴fixed motor washer	2
116	平衡翼固定轴固定轴固定轴固定轴fixed ISO 2.6*8 ISO 2.6*8	2
117	平衡翼固定轴固定轴固定轴固定轴fixed cable	1
118	平衡翼固定轴固定轴固定轴固定轴fixed AM1, 2*TPB1 push-rod M1.4*18	3
119	平衡翼固定轴固定轴固定轴固定轴fixed main motor	1
120	平衡翼固定轴固定轴固定轴固定轴fixed receiver	1
121	平衡翼固定轴固定轴固定轴固定轴fixed gears	1
122	平衡翼固定轴固定轴固定轴固定轴fixed M2*10 screw	2
123	平衡翼固定轴固定轴固定轴固定轴fixed M2 nuts	2